

# Technical data sheet

## Cable tray RKS-Magic® 60 A2

Item number: 6047640



Cable tray with integrated quick fastening system. The usable length of the cable tray is 3,000 mm.

The cable tray has continuous side perforations of 7 x 20 mm for the installation of additional connection and mounting components.

The perforation for direct threaded rod suspension has a diameter of 11 mm. Continuous equipotential bonding is guaranteed without additional components.

Magnetic shield insulation without cover 20 dB, with cover 50 dB. The cable tray is tested for the maintenance of electrical function, tested according to DIN 4102 Part 12 (tray widths 100–300 mm).

The mounting version and the mounting parameters correspond to the valid certificates.

You can find additional information in our fire protection systems catalogue.



**A2** Stainless steel

**2B** Bright, treated

### Master data

|                                   |                          |
|-----------------------------------|--------------------------|
| Item number                       | 6047640                  |
| Description 1                     | Cable tray RKSM          |
| Description 2                     | Magic, quick connector   |
| Manufacturer                      | OBO                      |
| Dimension                         | 60x200x3050              |
| Colour                            | stainless steel          |
| Material                          | Stainless steel          |
| Surface                           | Bright, treated          |
| Surface standard                  |                          |
| Smallest sales unit               | 3                        |
| Unit of quantity                  | Metre                    |
| Weight                            | 200.984 kg               |
| Weight unit                       | kg/100 m                 |
| CO Footprint (GWP) Cradle-to-Gate | 10,7405 kg COe / 1 Meter |

# Technical data sheet

## Cable tray RKS-Magic® 60 A2

Item number: 6047640



### Dimensions

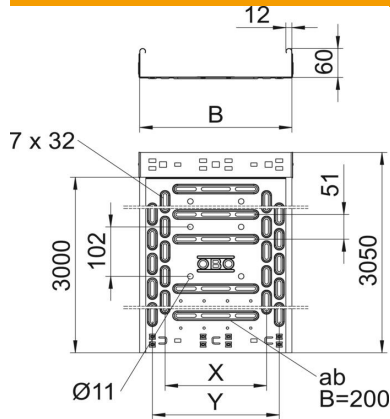

|                 |          |
|-----------------|----------|
| Length          | 3,050 mm |
| Width           | 200 mm   |
| Height          | 60 mm    |
| Plate thickness | 0.75 mm  |
| Dimension B     | 200 mm   |
| Dimension x     | 100 mm   |
| Dimension y     | 150 mm   |

### Technical data

|  |                       |
|--|-----------------------|
| Connector version                        | Integrated connector  |
| Mounting system fastening type           | Floor Ceiling Wall    |
| Walkable                                 | no                    |
| Base perforation                         | 1                     |
| Maintain electrical functions            | yes                   |
| With cover                               | no                    |
| Mounting perforation in base             | yes                   |
| NATO hole pattern                        | no                    |
| Usable cross-section                     | 118 cm <sup>2</sup>   |
| Usable cross-section                     | 11800 mm <sup>2</sup> |
| Rustproof steel, pickled                 | no                    |
| Side perforation                         | yes                   |
| Wide-span version                        | no                    |
| Magnetic shield insulation with cover    | 50 dB                 |
| Magnetic shield insulation without cover | 20 dB                 |
| Load test type according to IEC 61537    | Type II               |
| Usable length                            | 3000 mm               |
| Type of connector, cable support system  | Click fastening       |

# Technical data sheet

## Cable tray RKS-Magic® 60 A2

Item number: 6047640



### Loads

|                                   |          |
|-----------------------------------|----------|
| Insertable support spacings, min. | 1 m      |
| Insertable support spacings, max. | 2.5 m    |
| Support spacing 1.0 m             | 1.2 kN/m |
| Support spacing 1.5 m             | 0.9 kN/m |
| Support spacing 2.0 m             | 0.6 kN/m |
| Support spacing 2.5 m             | 0.4 kN/m |

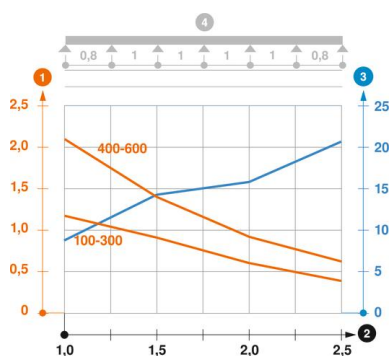

### Load diagram, cable tray, type RKSM 60

- 1 Permitted cable tray/ladder load in kN/m without man load
- 2 Support width in m
- 3 Rail bend in mm at permitted kN/m
- 4 Load scheme during testing
- Load curve with cable tray/ladder width in mm
- Strut bend curve according to support width