

Technical data sheet

90° vertical bend, rising, 60 FT

Item number: 7007006

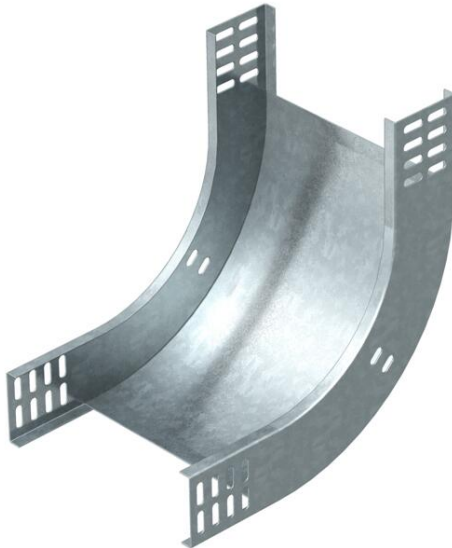

90° rising vertical bend, for all cable tray types of 60 mm side height.
The vertical bend is pushed over the end of the cable tray and screwed tight.
Fastening materials should be ordered separately.



St	Steel
FT	Hot-dip galvanised

Master data

Item number	7007006
Description 1	90° vertical bend
Description 2	rising
Manufacturer	OBO
Dimension	60x100
Colour	zinc
Material	Steel
Surface	Hot-dip galvanised
Surface standard	DIN EN ISO 1461
Smallest sales unit	1
Unit of quantity	Piece
Weight	71 kg
Weight unit	kg/100 pc.

Technical data sheet

90° vertical bend, rising, 60 FT

Item number: 7007006



Dimensions

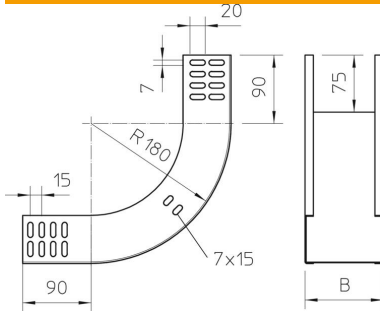

Width	100 mm
Width	4 in
Height	60 mm
Height	2 in
Plate thickness	1 mm
Dimension B	100 mm

Technical data

Bend (angle)	90°
Connector version	Without connectors
Maintain electrical functions	yes
Mounting perforation in base	no
NATO hole pattern	no
Change of direction	Vertical rising
Rustproof steel, pickled	no
Side perforation	no
Wide-span version	no
Type of connector, cable support system	Screwed