

Technical data sheet

Cover, angle-adjustable bend A2

Item number: 6037562



Cover for angle-adjustable bend fitting for lockable and screw-on cable trays in indoor and outdoor areas, to protect cables against damage and soiling. Fastening with pre-mounted sash locks and through attachment of the section cover. Suitable for all side heights.

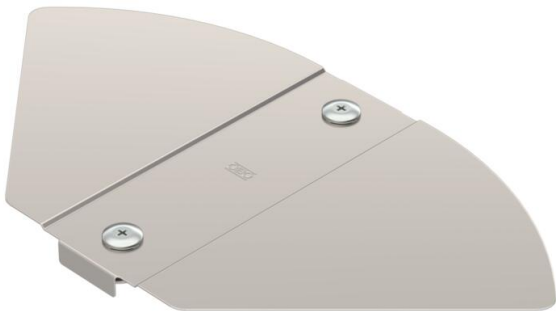

- A2

Stainless steel
- 2B

Bright, treated

Master data	
Item number	6037562
Type	RBD W 200 A2
Description 1	Cover
Description 2	for bend, adjustable
Manufacturer	OBO
Dimension	B200mm
Colour	stainless steel
Material	Stainless steel
Surface	Bright, treated
Surface standard	
Smallest sales unit	1
Unit of quantity	Piece
Weight	35 kg
Weight unit	kg/100 pc.
CO2 Footprint (GWP) Cradle-to-Gate	3,3492 kg CO2e / 1 Piece

Technical data sheet

Cover, angle-adjustable bend A2

Item number: 6037562



Dimensions

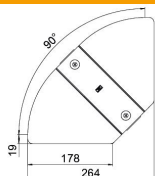

Width	200 mm
Plate thickness	0.75 mm
Dimension B	200 mm

Technical data

Bend (angle)	Adjustable
Number of turn buckles	2 St.
Fastening type	Sash lock
Maintain electrical functions	no
Suitable for mesh cable tray	no
Suitable for cable ladder	no
Suitable for cable tray	yes
Change of direction	Horizontal
Rustproof steel, pickled	no
Hinged	no
Permitted temperature range, max.	120 °C
Permitted temperature range, min.	-20 °C