

Technical data sheet

MS4121 mounting rail, slot 22 mm, FT, perforated

Item number: 1122926



Heavy-duty C profile rail for individual installation of support constructions, e.g. for cable trays or as a panel for switchgear cabinets. Can also be used for cable routing, in conjunction with clamp clips with a U foot.



| | |
|----|--------------------|
| St | Steel |
| FT | Hot-dip galvanised |

Master data

| | |
|-----------------------------------|-------------------------|
| Item number | 1122926 |
| Type | MS4121P6000FT |
| Description 1 | Profile rail |
| Description 2 | perforated, slot 22mm |
| Manufacturer | OBO |
| Dimension | 6000x41x21 |
| Material | Steel |
| Surface | Hot-dip galvanised |
| Surface standard | DIN EN ISO 1461 |
| Smallest sales unit | 6 |
| Unit of quantity | Metre |
| Weight | 184 kg |
| Weight unit | kg/100 m |
| CO Footprint (GWP) Cradle-to-Gate | 3,1821 kg COe / 1 Meter |

Technical data sheet

MS4121 mounting rail, slot 22 mm, FT, perforated

Item number: 1122926



Dimensions

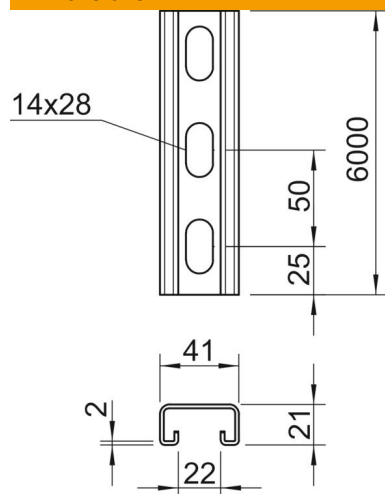

| | |
|-------------|----------|
| Length | 6,000 mm |
| Width | 41 mm |
| Height | 21 mm |
| Dimension L | 6,000 mm |

Technical data

| | |
|-------------------------------|----------------------|
| Breakable | no |
| Type of perforation | Perforated back |
| Version for | Single profile |
| Drill hole spacing, centre | 50 mm |
| Maintain electrical functions | yes |
| Hole size | 14x28 mm |
| Material thickness | 2 mm |
| With perforation | yes |
| With toothing | yes |
| Profile shape | C profile |
| Slot width | 22 mm |
| Static value A | 1.65 cm ² |
| Static value Iy | 0.95 cm |
| Static value Iz | 4.51 cm |
| Static value Wy | 0.89 cm ² |
| Static value Wz | 2.2 cm ² |