

# Technical data sheet

## Service outlet GRAF9-2 BA3, wet-cleaned with floor covering recess

Item number: 7405743



Service outlet with tube body for wet-cleaned floors for up to 12 individual Modul 45 devices in 3 UT4 universal supports, use in duct or trunking systems and system floors for indoor use.

Aluminium surface, polished, with a floor covering recess of 3 mm. For an installation depth of 65 mm.

Up to 9 installation devices can be used with a 50 mm central plate.

Service outlet for tube bodies for wet-cleaned floors, 3-compartment, for the installation of mounting support MT9. Three cover plates of type APMT5 can be installed. Application in trunking systems and in system floor in indoor areas.

Aluminium-polished surface with a floor covering recess of 3 mm For an installation depth of 65 mm.



**AIG** Cast aluminium

### Master data

Item number	7405743
Type	GRAF9-2 BA3
Description 1	Service outlet for wet care
Description 2	with floor covering recess
Manufacturer	OBO
Dimension	Ø325x73
Material	Cast aluminium
Smallest sales unit	1
Unit of quantity	Piece
Weight	258 kg
Weight unit	kg/100 pc.
CO2 Footprint (GWP) Cradle-to-Gate	4,2742 kg CO2e / 1 Piece

# Technical data sheet

Service outlet GRAF9-2 BA3, wet-cleaned with floor covering recess

Item number: 7405743



## Dimensions

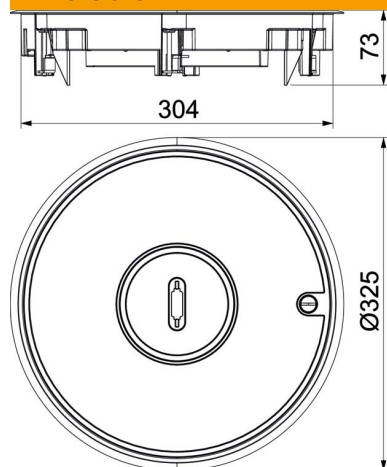

## Technical data

Number of installable devices	12
Number of mounting boxes	3
Version for	Round
Cable outlet version	Lowerable tube body
Floor covering protection frame	yes
Floor care	Wet
Seal installation option	yes
Floor height, min.	80 mm
Suitable for raised floor installation	yes
Suitable for screed-flush closed underfloor ducts	yes
Suitable for screed-covered underfloor ducts	yes
Suitable for cavity floor installation	yes
Suitable for wet care	yes
Suitable for underfloor box	350
Suitable for underfloor ducts	yes
With floor covering recess	yes
Nominal size for device installation units	R9
Frame version	Carpet protection frame
Protection rating (IP) when used	IP20
Protection rating (IP) when unused	IP45
Protection rating IK code	IK10
Heavy-duty version	yes
Clamping range D, max.	73 mm
Clamping range D, min.	4 mm
Installation system type	UT4
Vertical load, large area	to 10,000 N
Vertical load, small area	to 3,000 N
Approvals	VDE

# Technical data sheet

Service outlet GRAF9-2 BA3, wet-cleaned with floor covering recess

Item number: 7405743



## Technical data

Opening mechanism	Sash lock
Floor covering thickness	3 mm