

High loading capacity

The SSP support clamp is used to fasten various components, for example electrical installations, onto supporting building profiles and is particularly characterised by its high carrying capacity.

3 materials
(FT, V2A, V4A)

2 thread variants
(M6 and M8)

2 clamping ranges
(6 – 21, 20 – 40mm)

Particularly high
carrying capacity

BET-tested



OBO BETTERMANN Customer Service
Tel.: +49 (0) 23 73/89-1700 · E-Mail: export@obo.de
www.obo-bettermann.com

OBO
BETTERMANN

THINK CONNECTED.

The new SSP support clamp



This type of support clamp is pushed onto the support and fixed to the girder or flat iron using a pressure trough and bolt (M8). The hexagonal bolt has a WAF of 10 mm. In the clip element, two additional M6 or M8 threads are also incorporated, to fix threaded rods, for example.

Load value	F1 kN	F2 kN
SSP 6-21	1,75	1,5
SSP 20-40	1,4	1,3

Tightening torque

10 Nm

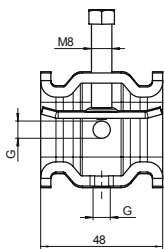
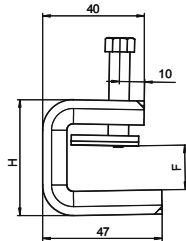
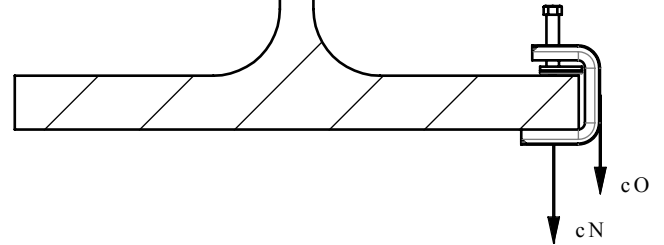

Type	Flange thickness mm	Dim. H mm	For threaded rod	Breaking load F2-F1 kN	Pack pcs	Weight kg/100 pcs	Item No.
SSP 6-21 M6 FT	6-21	46	M6	1,5-1,75	25	23,900	1486 232
SSP 6-21 M8 FT	6-21	46	M8	1,5-1,75	25	23,900	1486 282
St Steel							/100 pc.
FT Hot-dip galvanised							
SSP 6-21 M6 V2A	6-21	46	M6	1,5-1,75	25	23,200	1486 234
SSP 6-21 M8 V2A	6-21	46	M8	1,5-1,75	25	23,200	1486 284
V2A Stainless steel, grade 304							/100 pc.
SSP 6-21 M6 V4A	6-21	46	M6	1,5-1,75	25	23,200	1486 236
SSP 6-21 M8 V4A	6-21	46	M8	1,5-1,75	25	23,200	1486 286
V4A Stainless steel, grade 316 L							/100 pc.
SSP 20-40 M6 FT	20-40	65	M6	1,3-1,4	25	27,700	1486 238
SSP 20-40 M8 FT	20-40	65	M8	1,3-1,4	25	27,800	1486 288
St Steel							/100 pc.
FT Hot-dip galvanised							
SSP 20-40 M6 V2A	20-40	65	M6	1,3-1,4	25	27,700	1486 242
SSP 20-40 M8 V2A	20-40	65	M8	1,3-1,4	25	27,800	1486 292
V2A Stainless steel, grade 304							/100 pc.
SSP 20-40 M6 V4A	20-40	65	M6	1,3-1,4	25	27,700	1486 244
SSP 20-40 M8 V4A	20-40	65	M8	1,3-1,4	25	27,800	1486 294
V4A Stainless steel, grade 316 L							/100 pc.

OBO BETTERMANN Customer Service
 Tel.: +49(0)23 73/89-1700 · E-Mail: export@obo.de
www.obo-bettermann.com

