

LFS

Skirting duct system
Rapid 45



OBO. Used by professionals

Perfect solutions for every sort of electrical installation. User-friendly, practical products for fast, problem-free mounting. That's what matters to the professional. And that's what the OBO brand means.

For our customers that means:

- ▶ Comprehensive range with over 30,000 items
- ▶ In-house development and manufacture
- ▶ Continuous product maintenance and further product development
- ▶ Tested materials and manufacturing quality – witnessed by numerous national and international test marks and certificates – from GS and VDE marks to UL authorisation
- ▶ 5 years' guarantee on all surge protection products

- ▶ Active participation in national and international standardisation bodies
- ▶ Certified to DIN EN ISO 9001
- ▶ OBO hotline for advice and help with solving problems on site

OBO – branded products that pay off!





**Faster, closer, better
OBO on the spot**

Only those who are present on the spot with competent discussion partners can react flexibly and quickly to customers' wishes and markets. In over 50 countries OBO Bettermann offers systems for trade, crafts and industry through

to subsidiaries, regional branches and agents. The customer has been the focus of our operations for over 90 years.

Advice with system

Specialist employees will assist you with advice and action – regardless of whether it is a matter of technical infor-

mation, tender texts or software-supported planning aids. Active support for paperless order handling or the preparation of up-to-date analyses of products and markets are other services which have made OBO one of the leading manufacturers of building system technology.



**Fast and reliable
Logistics OBO-style**

In OBO the concept of quality not only stands for products and systems but also for our services. For instance we have developed special packaging solutions for transport, which together with the perfect OBO logistics ensure that your order will arrive in good condition, where it will be used – fast, safe and reliable.

OBO LFS seminars

Use the comprehensive information about the products in this catalogue – detailed information, the up-to-date seminar locations and dates can be obtained from our branches or on the Internet at www.obo-bettermann.com

LFS catalogue

You will find our complete line routing range in the LFS catalogue.



Knowledge at first hand

Progress through knowledge. Our aim is to inform you about current developments, trends, standards and regulations, to support and strengthen you in your competitive position. But the emphasis of our seminars is on the practical implementation of knowledge for your routine work. That is why our seminars are accompanied by practice-based workshops.



► **LFS seminar**
Modern line routing systems

**Particular tasks
require particular solutions**

The experts in *OBO Projekt und Systemtechnik* are specialists in the field of planning and engineering for industry, plant construction and major projects throughout the world. From processing of drawings to the detailed instructions for mounting – the focus is always on service for our customers.



OBO seminar programme

All the seminars at a glance.



The Rapid 45 skirting duct system

Attractive. And very flexible

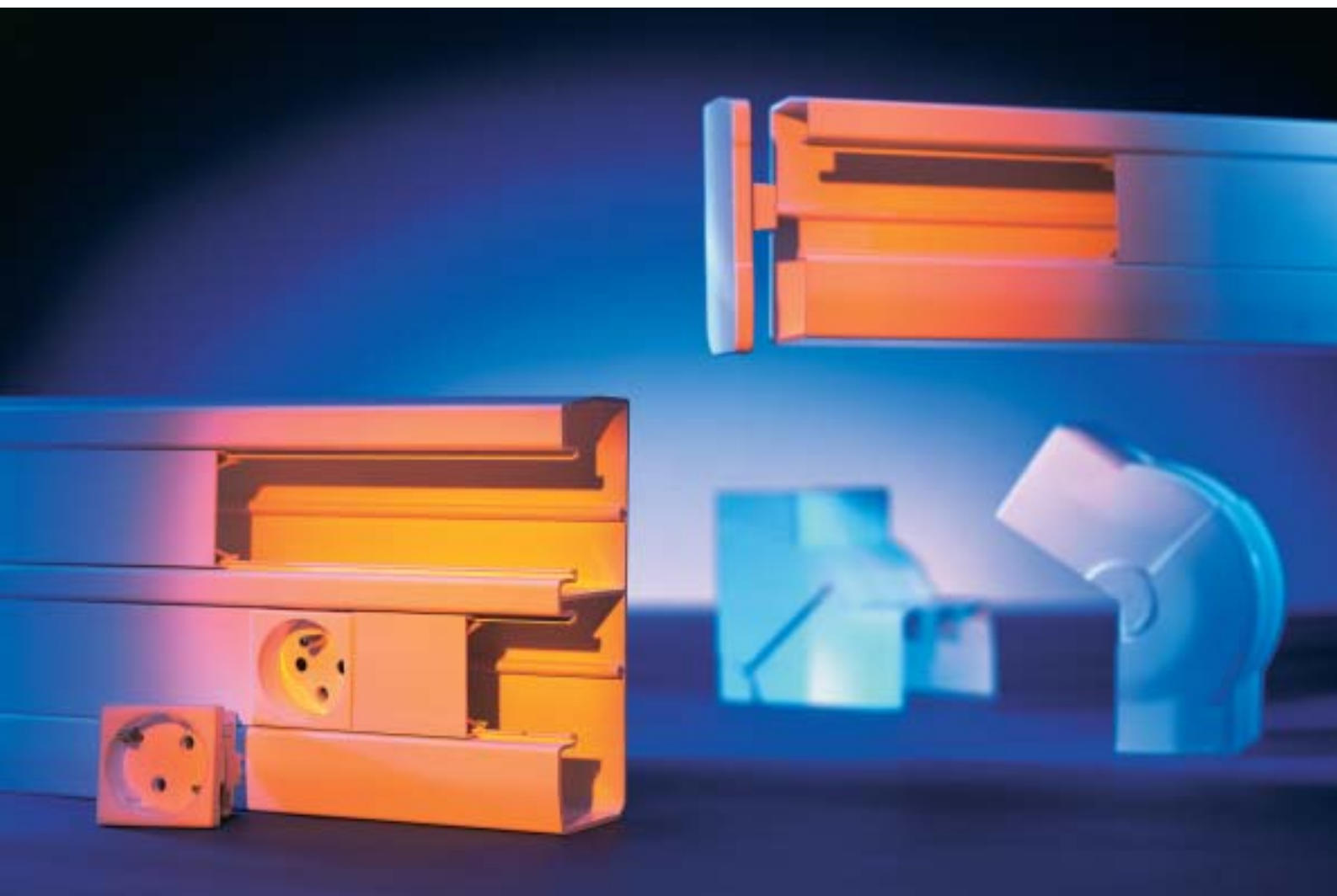

Flexible, attractive, versatile – these attributes characterise OBO's Rapid 45 skirting duct. The universal system can be installed as a dado rail or skirting duct, and offers ample space for a clear separation, for example of energy and data lines. Practical mouldings provide the ideal condition for perfect installation solutions both in the housing sector and for all industrial and commercial applications. The decisive advantage for fast and problem-free mounting of the final devices: switches, sockets and so on are clicked into the duct profile with one manipulation.



Perfect installation solutions for all areas

The OBO Rapid 45 system offers the possibility for achieving perfect cable routing everywhere: in the home, in office and administration buildings, and also in storage and workshop premises.

Rapid 45 is at home anywhere that flexible installation solutions are required. Switches and sockets are clicked in exactly where they are used. Fast and secure, neat and precise. Alterations and additions to the installation are possible at any time.

Problem-free adaptation to all spatial conditions

Variable mouldings allow problem-free mounting even if room corners are not one hundred per cent square. Exact adjustment of the duct, which is available in two sizes, to the spatial conditions is always possible.

The result in all cases is a perfect, attractive and practical installation. It makes no difference whether Rapid 45 is used as a dado rail or skirting duct.

Rapid 45 – the main advantages at a glance

- ▶ Modern design
- ▶ Duct profile available in two sizes
- ▶ Can be used as dado rail and skirting duct
- ▶ Variable mouldings allow adaptation to any space situation
- ▶ Clear separation of energy and data cables possible
- ▶ Time-saving mounting
- ▶ Final devices are just clicked into the profile
- ▶ Ideal system for new buildings, renovation and modernisation

In good shape

Rapid 45: Mouldings and accessories

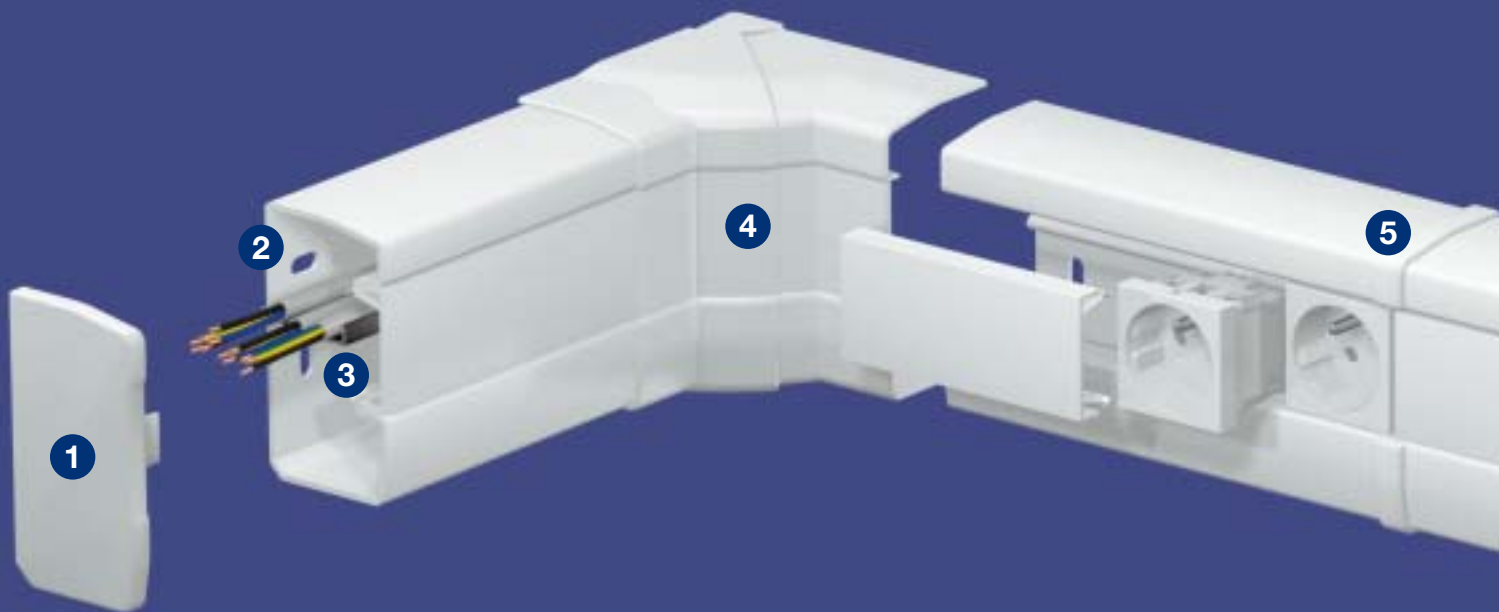

1 Terminations left and right



2 Simple alignment through horizontal and vertical oval base holes



3 Partition

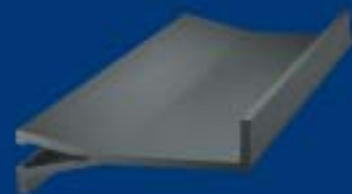

Simple mounting, perfect appearance

Characteristics of the attractive appearance of the OBO skirting duct Rapid 45 are the striking design with chamfered upper edges and the hood-shaped mouldings of the system. The plug-in principle permits fast and simple mounting both as a dado rail duct and as a skirting duct. And that works without any special tools and without special fastening elements. Horizontal and vertical oval holes also facilitate alignment for wall mounting.

Thinking round corners: Rapid 45 mouldings

A decisive plus with the Rapid 45 system are the carefully designed mouldings.

- ▶ Swivelling inner and outer corners fit perfectly into any angle.
- ▶ Cover elements cover joints and guarantee an optically flawless connection of duct segments.
- ▶ Terminations ensure neat closures.

Order is essential: Partitions prevent cable chaos

The system is completed by partitions, which are used to subdivide the inside of the installation duct, for example so as to ensure a clear separation of energy and data cables and thus end cable chaos once and for all.



4 Inner corner
80-103° swivelling



5 Joint connector



6 Outer corner
70-130° swivelling



**A clean solution:
packaging with protective film**

The Rapid 45 ducts are provided with a self-adhesive OBO protective film, which reliably prevents scratches and dirt during fitting. After installation of the ducts and fitting the devices the film is simply removed. The result: flawless surfaces.



Fast and clean

Simple installation with Rapid 45

One manipulation is sufficient

No more fiddling and no special tools are needed: switches and sockets are simply clicked into the guide profile of the duct. One manipulation is sufficient. Ready.

All sorted with the standard

The Rapid 45 skirting duct naturally complies with all conventional regulations and standards. Without further aids or covers the system achieves protection class IP 40.

Ample space for many lines

Both the mono and the duo-duct are very spacious and provide ample space.

The duct depth of 53 mm and the compact shape of the devices mean that the lines can be laid not only above and below, but also behind the switches and sockets.



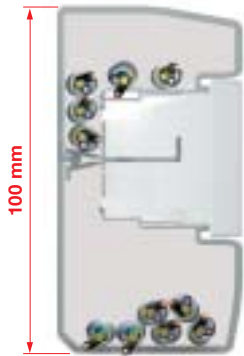

GEK 45/53100	without socket	with socket
empty	4080 mm ²	2596 mm ²
NYM 3 x 1.5 mm d = 10.5 mm	23	15
NYM 5 x 1.5 mm d = 12 mm	18	11
Telecom line J-Y (ea.) Y 2 x 2 x 0.6 d = 5 mm	104	66

Fill factor: 0.5 – a 50% capacity reserve is provided.



GEK 45/53160	without socket	with socket
empty	6480 mm ²	3696 mm ²
NYM 3 x 1.5 mm d = 10.5 mm	36	20
NYM 5 x 1.5 mm d = 12 mm	28	15
Telecom line J-Y (ea.) Y 2 x 2 x 0.6 d = 5 mm	156	96

Fill factor: 0.5 – a 50% capacity reserve is provided.

Installation examples



▲ Example 1: Rapid 45, height 100 mm
Installation as skirting duct

▼ Example 2: Rapid 45, height 160 mm
Installation as skirting duct





▲ Example 3: Rapid 45, height 100 mm
Installation as dado rail duct

▼ Example 4: Rapid 45, height 160 mm
Installation as dado rail duct



Skirting duct GEK 53100

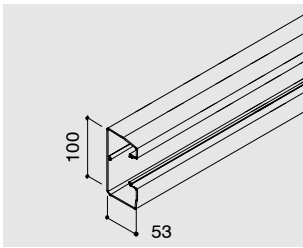

Lower part and cover
for wall mounting
Stock length: 2000 mm
Perforated base

Type	Material	Weight kg/m	Pack m	Colour	Order no.
GEK 45/53100	PVC	0.830	8	pure white	6116027

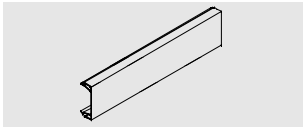

Duct cover
45 mm
Stock length: 2000 mm

Type	Material	Weight kg/m	Pack m	Colour	Order no.
GEK 45/D	PVC	0.400	8	pure white	6116108



Inner corner

Type	Material	Weight kg/pc	Pack qty	Colour	Order no.
GEK 45/I 53100	PVC	0.102	2	pure white	6116205

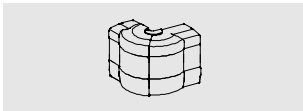

Outer corner

Type	Material	Weight kg/pc	Pack qty	Colour	Order no.
GEK 45/A 53100	PVC	0.166	2	pure white	6116264

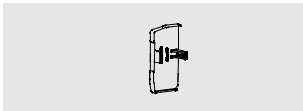

Termination, left-hand

Type	Material	Weight kg/pc	Pack qty	Colour	Order no.
GEK 45/EL 53100	PVC	0.022	6	pure white	6116302



Termination, right-hand

Type	Material	Weight kg/pc	Pack qty	Colour	Order no.
GEK 45/ER 53100	PVC	0.022	6	pure white	6116353

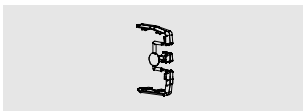

Joint connector

Type	Material	Weight kg/pc	Pack qty	Colour	Order no.
GEK 45/S 53100	PVC	0.007	6	pure white	6116150

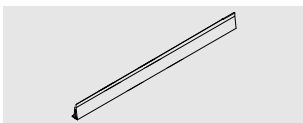

Partition

Type	Material	Weight kg/m	Pack m	Colour	Order no.
2371/40	PVC	0.135	60	grey	6023096

Skirting duct GEK 53160

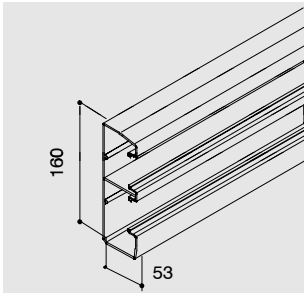

Lower part and cover
for wall mounting
Stock length: 2000 mm
Perforated base

Type	Material	Weight kg/m	Pack m	Colour	Order no.
GEK 45/53160	PVC	1.300	8	pure white	6116051

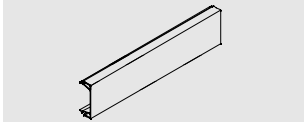

Duct cover
45 mm
Stock length: 2000 mm

Type	Material	Weight kg/m	Pack m	Colour	Order no.
GEK 45/D	PVC	0.400	8	pure white	6116108

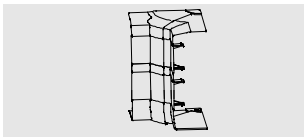

Inner corner

Type	Material	Weight kg/pc	Pack qty	Colour	Order no.
GEK 45/I 53160	PVC	0.123	2	pure white	6116221

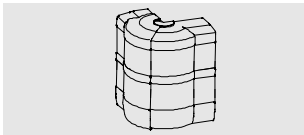

Outer corner

Type	Material	Weight kg/pc	Pack qty	Colour	Order no.
GEK 45/A 53160	PVC	0.208	2	pure white	6116280

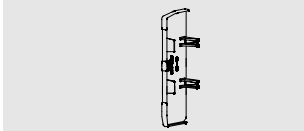

Termination, left-hand

Type	Material	Weight kg/pc	Pack qty	Colour	Order no.
GEK 45/EL 53160	PVC	0.035	6	pure white	6116329

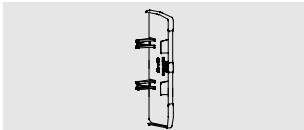

Termination, right-hand

Type	Material	Weight kg/pc	Pack qty	Colour	Order no.
GEK 45/ER 53160	PVC	0.035	6	pure white	6116388



Joint connector

Type	Material	Weight kg/pc	Pack qty	Colour	Order no.
GEK 45/S 53160	PVC	0.007	6	pure white	6116150

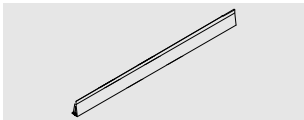

Partition

Type	Material	Weight kg/m	Pack m	Colour	Order no.
2371/40	PVC	0.135	60	grey	6023096

French sockets

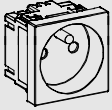
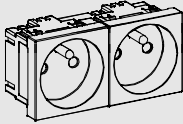
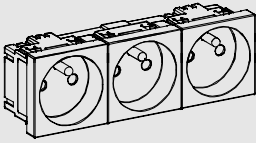
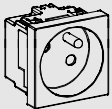
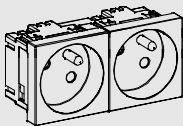
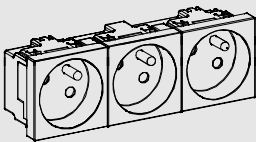
	Single French socket	Type	Material	Weight kg/pc	Pack qty	Colour	Order no.
		SKSF 90 RW 1	PVC	0,038	1	pure white	6117102
		SKSF 90 OR 1	PVC	0,038	1	orange	6117104
		SKSF 90 GN 1	PVC	0,038	1	green	6117106
		SKSF 90 RT 1	PVC	0,038	1	red	6117108
	Double French socket	Type	Material	Weight kg/pc	Pack qty	Colour	Order no.
		SKSF 90 RW 2	PVC	0,075	1	pure white	6117111
		SKSF 90 OR 2	PVC	0,075	1	orange	6117113
		SKSF 90 GN 2	PVC	0,075	1	green	6117115
		SKSF 90 RT 2	PVC	0,075	1	red	6117117
	Triple French socket	Type	Material	Weight kg/pc	Pack qty	Colour	Order no.
		SKSF 90 RW 3	PVC	0,103	1	pure white	6117123
		SKSF 90 OR 3	PVC	0,103	1	orange	6117125
		SKSF 90 GN 3	PVC	0,103	1	green	6117127
		SKSF 90 RT 3	PVC	0,103	1	red	6117129
	Single French socket 33°	Type	Material	Weight kg/pc	Pack qty	Colour	Order no.
		SKSF 33 RW 1	PVC	0,038	1	pure white	6117140
		SKSF 33 OR 1	PVC	0,038	1	orange	6117142
		SKSF 33 GN 1	PVC	0,038	1	green	6117144
		SKSF 33 RT 1	PVC	0,038	1	red	6117146
	Double French socket 33°	Type	Material	Weight kg/pc	Pack qty	Colour	Order no.
		SKSF 33 RW 2	PVC	0,075	1	pure white	6117151
		SKSF 33 OR 2	PVC	0,075	1	orange	6117153
		SKSF 33 GN 2	PVC	0,075	1	green	6117155
		SKSF 33 RT 2	PVC	0,075	1	red	6117157
	Triple French socket 33°	Type	Material	Weight kg/pc	Pack qty	Colour	Order no.
		SKSF 33 RW 3	PVC	0,103	1	pure white	6117162
		SKSF 33 OR 3	PVC	0,103	1	orange	6117164
		SKSF 33 GN 3	PVC	0,103	1	green	6117166
		SKSF 33 RT 3	PVC	0,103	1	red	6117168

Schuko sockets

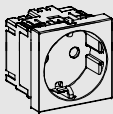
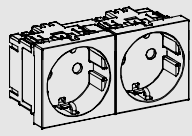
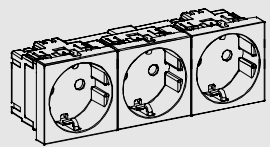
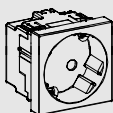
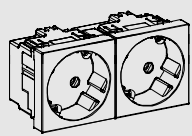
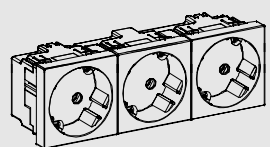
	Single socket	Type	Material	Weight kg/pc	Pack qty	Colour	Order no.
		SKSD 90 RW 1	PVC	0,038	1	pure white	6117001
		SKSD 90 OR 1	PVC	0,038	1	orange	6117003
		SKSD 90 GN 1	PVC	0,038	1	green	6117005
		SKSD 90 RT 1	PVC	0,038	1	red	6117007
	Double socket	Type	Material	Weight kg/pc	Pack qty	Colour	Order no.
		SKSD 90 RW 2	PVC	0,075	1	pure white	6117012
		SKSD 90 OR 2	PVC	0,075	1	orange	6117014
		SKSD 90 GN 2	PVC	0,075	1	green	6117016
		SKSD 90 RT 2	PVC	0,075	1	red	6117018
	Triple socket	Type	Material	Weight kg/pc	Pack qty	Colour	Order no.
		SKSD 90 RW 3	PVC	0,103	1	pure white	6117023
		SKSD 90 OR 3	PVC	0,103	1	orange	6117025
		SKSD 90 GN 3	PVC	0,103	1	green	6117027
		SKSD 90 RT 3	PVC	0,103	1	red	6117029
	Single socket 33°	Type	Material	Weight kg/pc	Pack qty	Colour	Order no.
		SKSD 33 RW 1	PVC	0,038	1	pure white	6117041
		SKSD 33 OR 1	PVC	0,038	1	orange	6117043
		SKSD 33 GN 1	PVC	0,038	1	green	6117045
		SKSD 33 RT 1	PVC	0,038	1	red	6117047
	Double socket 33°	Type	Material	Weight kg/pc	Pack qty	Colour	Order no.
		SKSD 33 RW 2	PVC	0,075	1	pure white	6117052
		SKSD 33 OR 2	PVC	0,075	1	orange	6117054
		SKSD 33 GN 2	PVC	0,075	1	green	6117056
		SKSD 33 RT 2	PVC	0,075	1	red	6117058
	Triple socket 33°	Type	Material	Weight kg/pc	Pack qty	Colour	Order no.
		SKSD 33 RW 3	PVC	0,103	1	pure white	6117063
		SKSD 33 OR 3	PVC	0,103	1	orange	6117065
		SKSD 33 GN 3	PVC	0,103	1	green	6117067
		SKSD 33 RT 3	PVC	0,103	1	red	6117069

OBO's networked systems

VBS Connection and fastening systems		Connection systems Fastening systems Beam clamp systems Rail systems Screw-in and knock-in systems
TBS Transient voltage and lightning protection systems		Surge protection systems Equipotential bonding systems Earthing systems Lightning protection systems
KTS Cable support systems		Mounting systems Cable tray systems Mesh cable tray systems Cable ladder systems Vertical ladder systems Modular systems Luminaire support systems GKS cable tray systems Distribution boxes Stainless-steel components
BSS Fire protection systems		Cable insulation Function maintenance Fire protection ducts
LFS Cable routing systems		Installation duct systems Skirting duct systems IBIS Integral Media columns
UFS Underfloor systems		Underfloor installation systems ISO A duct system Cavity and false floor systems

OBO BETTERMANN GmbH & Co.
 P.O. Box 1120 · 58694 Menden · Germany
 Tel. +49 (0)23 73 89-0 · Fax +49 (0)23 73 89-238
 E-mail: info@obo.de · www.obo-bettermann.com

Central technical hotline
 Tel. +49 (0)23 73 89-1500
 Fax +49 (0)23 73 89-1550
 E-mail hotline@obo.de

